

Dimensions : Millimetres [Inches]  
 Estimated weight: 0,63 kg (1,4 lbs)

TITLE: <b>500-111-15</b> Compact control panel for NLC, 15 channels					
DRAWING No.:				Sheet No.:	DRAWN BY:
<b>500-111-15</b>				<b>1</b>	<b>LSA</b>
SCALE:	SIZE:	REV. NO.:	TOLERANCES:	REVIEWED BY:	CREATION DATE:
<b>1 : 2</b>	<b>A3</b>		<b>DS/ISO 2768-f</b>	<b>PHH</b>	<b>31-10-2024</b>
MATERIAL DESCRIPTION:			(50µ) Black anodized according to MIL-A 8625F		
<b>Aluminium 6082</b>					



Lopolight ApS  
 Bakkegaardsvej 513  
 DK-3050, Humlebaek  
 Denmark  
 www.lopolight.com

Tel: (+45) 32 48 50 30  
 info@lopolight.com

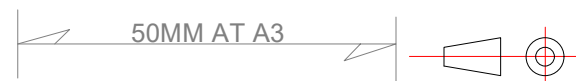

This Drawing, and the information within, is the property of Lopolight ApS and may not be used in any form without express permission there from. Lopolight reserves the right to change this drawing and assumes no liability for the information communicated herein. Use of dimensions and other information in this drawing is at the users own risk.